

# SA Rod end BEM10-20-501-DURBAL - BEM10-20-501-DURBAL

<https://www.123bearing.ca/bearing-housing/rod-end/sa/bem10-20-501-durbal>

## BEM10-20-501



male thread:  
maintenance free,  
adapter sizes  
according to  
DIN ISO 12240-4,  
series K



**DURBAL® heavy-duty rod ends  
with integral spherical  
plain bearing**

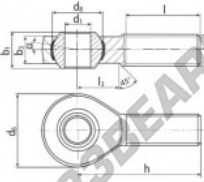

rod end housing:  
forged steel, tempered, rolled thread,  
surface galvanized, free of Cr-VI

joint ball:  
ball bearing steel, hardened and ground,  
surface superfinished and chromium  
plated

race:  
nylon / teflon / glass fibre compound

tolerances:  
see page 10

order number		measurements [mm]		weight		basic load rating	
type	type	d <sub>1</sub>	d <sub>2</sub>	d <sub>3</sub>	d <sub>4</sub>	b <sub>1</sub>	b <sub>2</sub>
BEM 10 -20 -501	M 10	10	M 10	28	19,00	14	10,5
measurements [mm]		weight		basic load rating		stat.	
type	h	l	l <sub>3</sub>	α <sub>1</sub> °	α <sub>2</sub> °	C	C <sub>0</sub>
BEM 10	48	29	15	13,5	8,0	0,060	10420 22600

## PRODUCT FEATURES

Brand	DURBAL
N° Ean13	3663952507811
Inside diameter	10 mm
Outside diameter	28 mm
Thickness	14 mm
Type	SA
Weight	60 g
Thread	Right-hand thread
Lubrication	without
Packaging	1

[contact@123bearing.ca](mailto:contact@123bearing.ca)

+1(646) 712 9672

CRT4 de Lesquin 60 Rue Du Haut De Sainghin 59273 Fretin FRANCE