

SI Rod end BEF12-20-501-DURBAL - BEF12-20-501-DURBAL

<https://www.123bearing.ca/bearing-housing/rod-end/si/bef12-20-501-durbal>

BEF12-20-501



rod end housing:
forged steel, tempered, surface galvanized, free of Cr-VI

joint ball:
ball bearing steel, hardened and ground, surface superfinished and chromium plated

race:
nylon / teflon / glass fibre compound

tolerances:
see page 10

DURBAL® heavy-duty rod ends with integral spherical plain bearing

female thread:
maintenance free, adapter sizes according to DIN ISO 12240-4, series K, thread according to ISO 8139

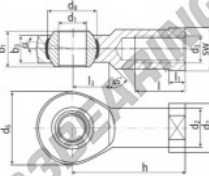

order number		measurements [mm]									
type	right-hand thread	d1	d2	d3	d4	d5	d6	d7	d8	h	l
BEF 12	-20	-501	12	17,5	M 12	32	22	22,17	16	12,0	
		measurements [mm]									
type	h	l	l1	l2	l3	SW	α_1 [°]	α_2 [°]	weight [kg]	basic load rating dyn. C [N]	stat. C0 [N]
BEF 12	50	22	6,5	16	19		13,0	8,0	0,109	12425	33400

PRODUCT FEATURES

Brand	DURBAL
N° Ean13	3663952508085
Inside diameter	12 mm
Outside diameter	32 mm
Thickness	16 mm
Type	SI
Weight	109 g
Thread	Right-hand thread
Lubrication	without
Packaging	1

contact@123bearing.ca

+1(646) 712 9672

CRT4 de Lesquin 60 Rue Du Haut De Sainghin 59273 Fretin FRANCE