

SI Rod end

EF25-20-502-DURBAL - EF25-20-502-DURBAL

<https://www.123bearing.ca/bearing-housing/rod-end/si/ef25-20-502-durbal>

EF25-20-502



rod end housing:
forged steel, tempered, surface galvanized, free of Cr VI

joint ball:
ball bearing steel, hardened and ground, surface superfinished and chromium plated

race:
nylon / teflon / glass fibre compound

tolerances:
see page 10

DURBAL® heavy-duty rod ends with integral spherical plain bearing

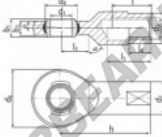

female thread:
maintenance free, adapter sizes according to DIN ISO 12240-4, series E / EH



order number		measurements [mm]										
type	right-hand thread	d ₁	d ₂	d ₃	d ₄	d ₅	d ₆	d ₈	b ₁	b ₂	b ₃	h
EF 25	-20	-502	25	35	M 24 x 2	62	35,5	20	16	94		
measurements [mm]		weight		basic load rating								
type	l	l ₃	l ₄	l ₅	SW	α ₁ ¹ [°]	α ₂ ¹ [°]	B ₀₁	C ₀ [N]	C ₁₀ [N]		
EF 25	42	30			30	7,5	3,5	0,573	42400	119100		

PRODUCT FEATURES

Brand	DURBAL
N° Ean13	3663952508481
Inside diameter	25 mm
Inside diameter	0.984" inch
Outside diameter	62 mm
Outside diameter	2.441" inch
Thickness	20 mm
Thickness	0.787" inch
Type	SI
Weight	573 g
Thread	Left-hand thread
Lubrication	without
Packaging	1

contact@123bearing.ca

+1(646) 712 9672

CRT4 de Lesquin 60 Rue Du Haut De Sainghin 59273 Fretin FRANCE