

SI Rod end

BEF1-4-20-501-DURBAL - BEF1-4-20-501-DURBAL

<https://www.123bearing.ca/bearing-housing/rod-end/si/bef1-4-20-501-durbal>

BEF1/4-20-501



rod end housing:
forged steel, tempered, surface galvanized, free of Cr VI

joint ball:
ball bearing steel, hardened and ground, surface superfinished and chromium plated

race:
nylon / teflon / glass fibre compound

tolerances:
see page 10

DURBAL® heavy-duty rod ends with integral spherical plain bearing

female thread:
maintenance free, dimensions in inches

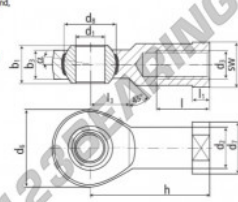

order number		measurements [inches]										weight	basic load rating	
type	right hand thread	left hand thread	d ₁	d ₂	d ₃	class 2	d ₅	d ₇	d ₈	b ₁	b ₂		C ₁₀	C ₅₀
BEF	1/4 - 20	-501	.250	.374	.2500-28 UNF		.750	.469	.516	.374	.283			
		measurements [inches]										weight	basic load rating	
type	h	l	l ₁	l ₂	SW	α ₁ [°]	α ₂ [°]	l _q	C ₁₀ [N]	C ₅₀ [N]				
BEF	1/4	1.338	.716	.185	.385	.381	17,5	8,0	0,027	4290	11400			

PRODUCT FEATURES

Brand	DURBAL
N° Ean13	3663952510521
Inside diameter	6.35 mm
Outside diameter	19.05 mm
Thickness	9.5 mm
Type	SI
Weight	27 g
Thread	Right-hand thread
Lubrication	without
Packaging	1

contact@123bearing.ca

+1(646) 712 9672

CRT4 de Lesquin 60 Rue Du Haut De Sainghin 59273 Fretin FRANCE